

# MULTI4 V3 Combo Model



The Multi 4 Combo flexibility, changing from bench to hand held type in 10 seconds without any tools, allows a quick and simple adaptation to any size and type of parts.

## Technical Specifications

<b>Dimensions kit établi :</b> (L x W x H) 412 x 310 x 656 mm	<b>Bench kit weight :</b> 18 kg
<p><b>Capacity :</b></p> <ul style="list-style-type: none"> <li>Tungsten carbide stylus with 90°sharpening angle (available with 60° and 120°angle)</li> <li>"Quick shift function": unclutching column allowing quick movement then fine positioning of the marking head height with reference to the part</li> <li>Adjustable character height, depending on the marking zone size in 0.1mm steps (See table below)</li> <li>Font matrix: 5x7 ; 9x13 ,continuous and custom (5 levels of dots concentration per character)</li> <li>Alphanumeric marking (text, symbol, serial number, variable), 2D code, logo *</li> <li>Timestamp and shift code management</li> <li>Linear, angular and circular marking</li> <li>Configurable pause and parking points</li> <li>RS232 and USB ports (host and device), 3 inputs/4 outputs</li> <li>Energy saving : 2 configurable sleep mode</li> <li>Quick update, marking files transfer and "production follow up "files (Txt. format) export via USB port</li> <li>Maintenance and autodiagnosis (5 control points) menu</li> <li>Adjustable impact force with 6 levels and speed with 5 levels</li> <li>"Easy shift" function : preview of movements</li> <li><i>IDI Premium</i> : Control and intelligent driving impact</li> </ul> <p><b>Muti 4 control box multilanguage:</b></p> <ul style="list-style-type: none"> <li>(L x W x H) 370 x 215 x 139 mm</li> <li>Weight from 3.7 to 4.9 Kg with battery</li> <li>HD colour graphic screen (640 x 480 px)</li> <li>40 Mb Memory up to 20 000 files</li> <li>Ergonomics: standing foot and transport handle</li> </ul> <p><i>*Optional logo marking, available with TechnoLOG software</i></p>	<p><b>Environment and power :</b></p> <ul style="list-style-type: none"> <li>Operating temperature : 0° to 45 ° (from 32°F to 115°F)</li> <li>Electrical power : 90 to 240v</li> <li>Power/ Frequency : 250 W / 50 to 60 Hz</li> </ul> <p><b>Standards :</b></p> <ul style="list-style-type: none"> <li>Machinery directive: 2006/42/CE</li> <li>Electro-magnetic compatibility : 2004/108/CE</li> <li>Low power directive : 2006/95/CE</li> <li>FCC directive– chapter 15</li> </ul> <p><b>Options :</b></p> <ul style="list-style-type: none"> <li><b>Software :</b> <ul style="list-style-type: none"> <li>TechnoLOG (Logo design)</li> <li>TechnoPROD (Production follow up)</li> <li>TechnoSAVE (Transfer and save files)</li> <li>TechnoWINDOWS ( Driving via a windows PC)</li> <li>TechnoMATRIX (Datamatrix code edition)</li> </ul> </li> <li>Maintenance kit</li> <li>5 / 10 m cable</li> <li>RJ 45 (Ethernet)</li> <li>8 inputs/8 outputs kit</li> <li>Electrical column / extended (+100mm)</li> <li>Large base (on request)</li> <li>Rotary D axis high or simple capability</li> <li>Automatic plate feeder</li> <li>Plate support</li> <li>Part support</li> <li>Protection bellow for mechanical parts</li> <li>External cycle start command (pedal/button box)</li> <li>Second handling handle (available 07/2012)</li> <li>24 V Battery kit ( autonomous operations)</li> <li>Transport trolley</li> </ul>
<b>→ Production capacity up to 5,000 parts on 3 shifts, depending on validation of the application by our technical service</b>	

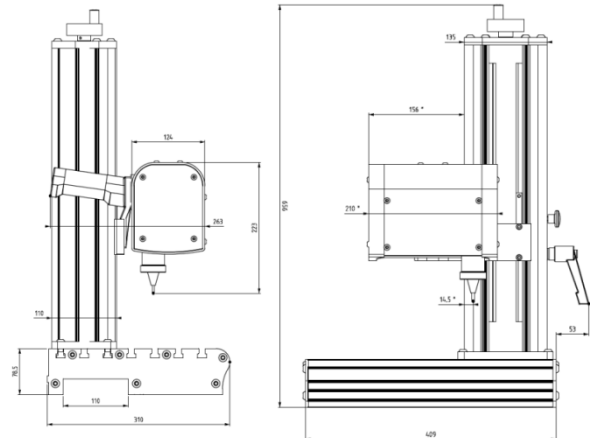

All dimensions in mm  
Drawing is MULTI 4 V3 120 standard  
\* Dimensions vary, depending on configuration  
(See table here under)

### Delivered with :

- 3m cable
- Control box power cable
- Quickshift bench kit with screw type « Z » axis
- Combo fixation plate
- Unclutching screw
- Adjustable foot
- Handle equipped with cycle start trigger and excentric nut

Configuration	Marking Zone (mm)	Dimensions (mm)	Weight (kg)	Character Height (mm)	ITEM CODE
<b>Compact</b>	50 x 60	145 x 266 x 226	4.8	From 0.6 to 59.9	<b>NA30120-P</b>
<b>Standard</b>	120 x 60	215 x 266 x 226	5.3	From 0.6 to 89.9	<b>NA30130-P</b>

66 Granby Street  
Bloomfield CT 06002  
(800) 442-6275  
[sales@dapramarking.com](mailto:sales@dapramarking.com)

**MULTI4**<sup>®</sup>  
DOT PEEN & SCRIBING